

KI-151 R44 Pop-Out Float Cylinder Service Kit Instructions

NOTE

Visit www.robinsonheli.com to verify kit instructions are current revision.

ITEM NUMBER	PART NUMBER	DESCRIPTION	QTY PER KI-151
KIT CONTENTS			
1	KI-151 INSTR	Kit Instructions	1
2	MT545-1	Pin Assembly	1
3	MT546-1	Diffuser	1
4	MT546-2	Adapter	1
5	MT546-4	Bleed Fitting Assembly	1

Kit Instructions

1. Verify kit contents match above list. Contact RHC Customer Service if parts are missing or damaged.
2. Review instructions before installation. Contact RHC Technical Support if you have questions.

WARNING

D679 Cylinder contents are under extreme pressure. Install MT545-1 pin assembly in D757-1 valve assembly during maintenance to prevent cylinder discharge.

A. Cylinder Removal

1. Refer to Figure 1. Install MT545-1 pin assembly in D757-1 valve assembly.
2. Disconnect D674-1 hose assembly from valve fitting. Install MT546-1 diffuser on valve fitting and special torque diffuser to 120 in.-lb. Cap hose to prevent foreign object contamination.
3. Refer to R44 Illustrated Parts Catalog (IPC) Figure 11-21B. Remove hardware securing D761-2 cover to valve and D761-1 support. Remove cover.
4. Remove hardware securing D761-1 support to valve. Do not kink cable.
5. Refer to Figure 1. Cut and discard MS3367-4-9 ty-rap secured to D760-1 trigger. Disengage D676-1 cable assembly ball from trigger, but do not kink cable.
6. Remove screws securing D669-3 strap to D669-1 cradle assembly and remove strap. Carefully remove cylinder.

Kit Instructions (continued)**B. Cylinder Depressurization**

1. Remove cylinder per Part A. Refer to Figure 1. Verify MT545-1 pin assembly and MT546-1 diffuser are properly installed.

CAUTION

Use appropriate eye and hearing protection.

2. Remove D760-7 cap (etched with "FILL PORT") from valve assembly. A loud pop may be heard when cap's seal is broken.
3. In a well-ventilated area, slowly screw MT546-4 bleed fitting assembly into fill-port until the noise of escaping gas is heard. Screw fitting in or out to adjust flow rate. Finish bleeding cylinder with bleed fitting fully in. When noise ceases, verify cylinder pressure gage indicates zero. Remove bleed fitting.
4. Install cap in valve assembly and special torque cap to 40 in.-lb.
5. Review R44 Maintenance Manual (MM) § 5.665 and evaluate cylinder life and hydrostatic test status.

C. Filling Cylinder

1. Review R44 Maintenance Manual (MM) § 5.665 and evaluate cylinder life and hydrostatic test status.
2. Perform R44 Service Bulletin SB-80, if required.
3. Refer to Figure 1. Install MT545-1 pin assembly in D757-1 valve assembly. Install MT546-1 diffuser on valve fitting and special torque diffuser to 120 in.-lb.

CAUTION

Use appropriate eye and hearing protection.

4. Remove D760-7 cap (etched with "FILL PORT") from valve assembly. A loud pop may be heard when cap's seal is broken.
5. Fill cylinder per MM § 5.665, thru step 5.
6. Remove fill hose and MT546-2 adapter assembly.
7. Remove & discard old o-ring from cap. Lightly coat new MS28778-2 o-ring with A257-19 lubricant and install o-ring on fill-port cap at base of threads. Install cap in valve assembly and special torque cap to 40 in.-lb.

Kit Instructions (continued)**D. Cylinder Installation**

1. Perform R44 Service Bulletin SB-80, if required. Fill cylinder per Part C if not previously accomplished.
2. Refer to Figure 1. Install MT545-1 pin assembly in D757-1 valve assembly.
3. Refer to R44 Illustrated Parts Catalog (IPC) Figure 11-21B. Verify A701-5 (anti-chafe) tape protects cylinder where cylinder base contacts cabin structure in three locations. Carefully position cylinder in D669-5 strap and D669-1 cradle assembly.
4. Engage D676-1 cable assembly ball in D760-1 trigger; do not kink cable. Install MS3367-4-9 ty-rap as shown. Cinch ty-rap until snug without over-tightening, and trim tip flush with head. Install hardware securing D761-1 support to valve.
5. Verify cable housing protrudes through clamps on support flush-to-0.200 inch maximum. Adjust as necessary.
6. Rotate cylinder as required to minimize cable bending and ensure clearance with cabin structure.
7. Verify D682-6 decal is in specified location. If decal location is incorrect, remove old decal and install new decal on cylinder. Install screws securing D669-3 strap to cradle assembly.
8. Install hardware securing D761-2 cover to valve and D761-1 support.
9. Remove MT546-1 diffuser, if installed. Connect D674-1 hose assembly to valve fitting. Orient hose as required to maintain minimum 0.25 inch clearance to cylinder and adjacent vertical panel. Special torque B-nut per R44 Maintenance Manual (MM) § 1.330 and torque stripe per MM Figure 2-1.
10. Rig inflation lever per MM § 5.680.
11. Remove MT545-1 pin assembly from D757-1 valve assembly.
12. Make appropriate maintenance record entries.

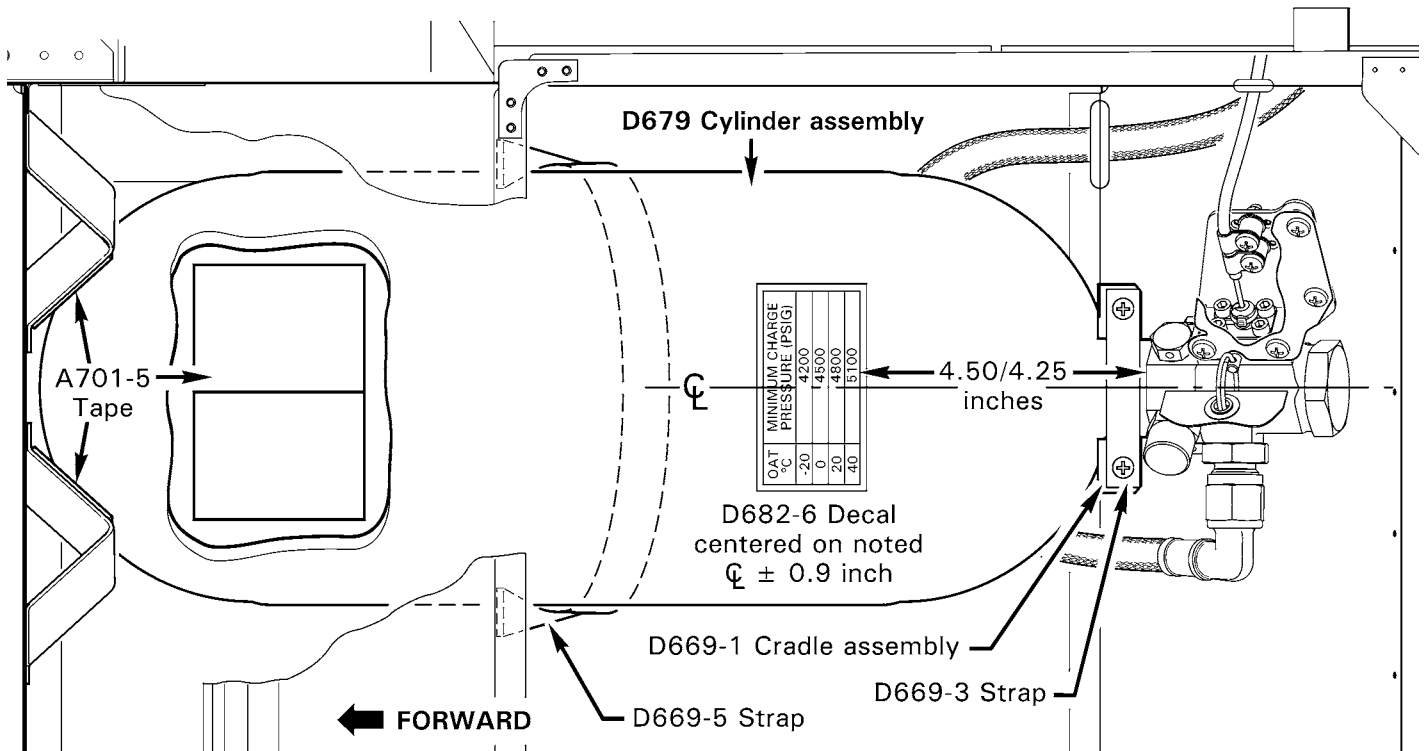
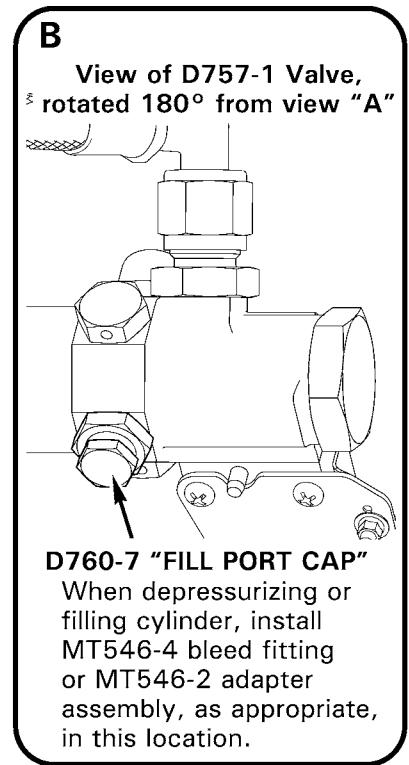
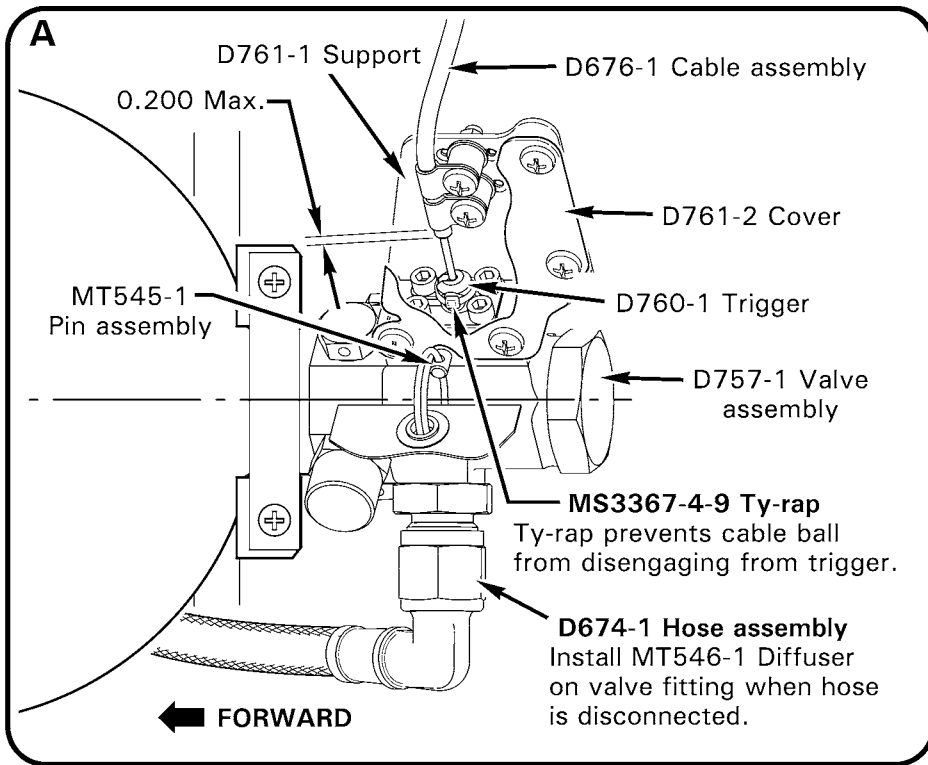

FIGURE 1

(View looking down, with left seat assembly hinged forward.)